

LIMERICK CITY AND COUNTY COUNCIL

FOYNES SERVICE AREA SCHEME, 2019

**(FORMING PART OF FOYNES TO LIMERICK
ROAD (INCLUDING ADARE BYPASS))**



Comhairle Cathrach
& Contae **Luimnigh**

Limerick City
& County Council

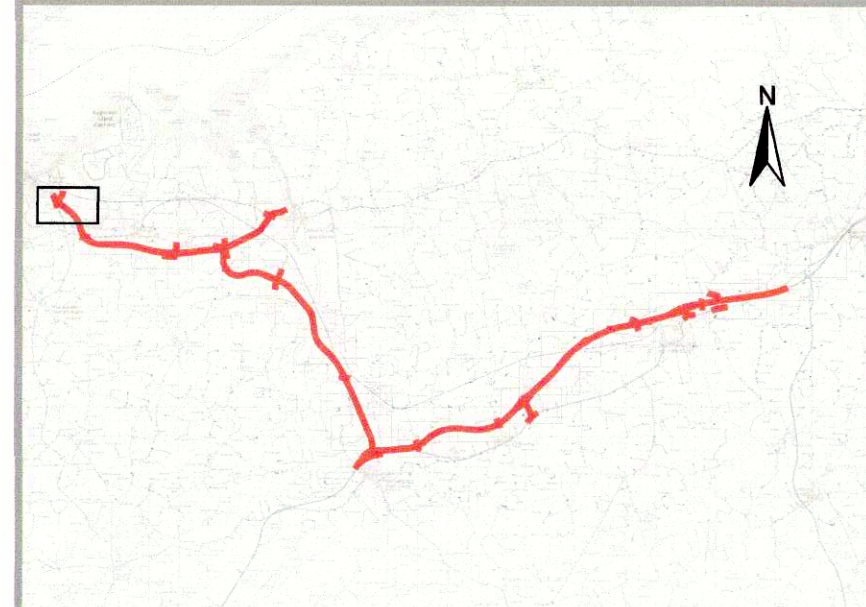
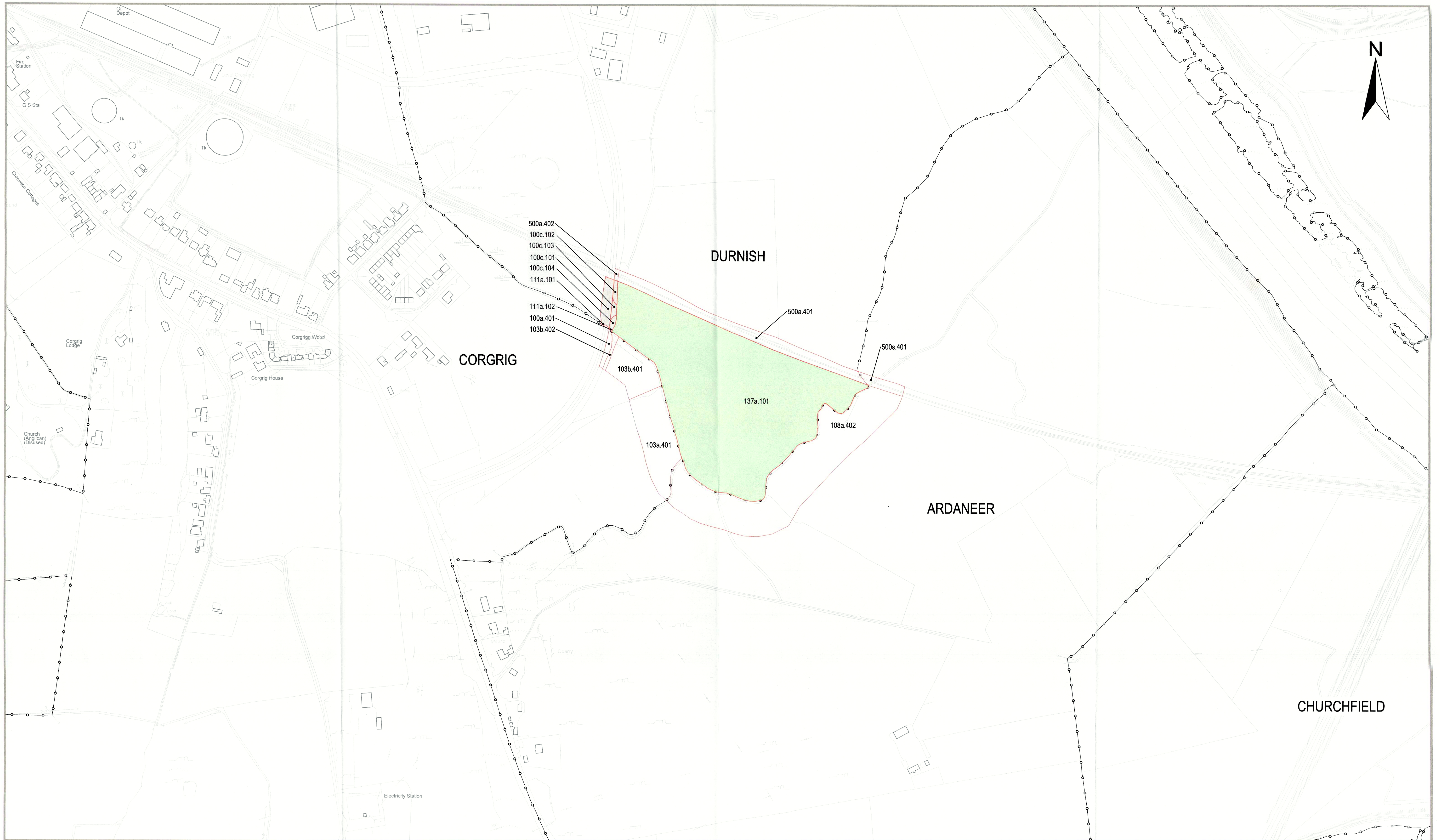





Comhairle Cathrach agus Contae Luimnigh
LIMERICK CITY AND COUNTY COUNCIL
 Corporate Headquarters
 Merchants Quay
 Limerick
 V94 EH90

LEGEND:

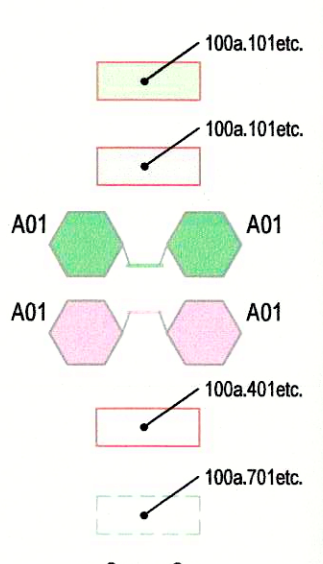
- Schedule 1 Part 1 Section 1 & II
Lands on which it is proposed to provide a Service Area
- Schedule 1 Part 2 Section 1 & II
Lands not forming part of the Service Area but forming part of the Scheme
- Schedule 3 Part 1
Public Rights of Way proposed to be extinguished
- Schedule 3 Part 2
Private Rights of Way proposed to be extinguished
- Schedule 4
Lands which Means of Direct Access are affected by Service Area
- Schedule 7 Part 1 & 2
Planning Permissions proposed to be revoked or modified
- Townland Boundary





 © Ordnance Survey Ireland, 2019. All rights reserved.
 Licence No. 2019 / 09 / CCMA / Limerick City and County Council.

PLAN
 Scale 1:2500 @ A1

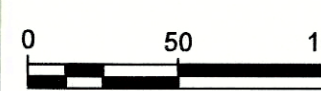

Prepared by: DY
 Checked by: MH / IC
 Drawing No.: FLRS-DEP-SER-01

Scale: 1:2500 @ A1
 Approved by: SMcG

LIMERICK CITY AND COUNTY COUNCIL
FOYNES SERVICE AREA SCHEME, 2019
(FORMING PART OF FOYNES TO LIMERICK ROAD (INCLUDING ADARE BYPASS))
DEPOSIT MAP - SHEET 01 OF 01

Dated the 3rd day of December 2019 Seal:
 PRESENT when the Common Seal of LIMERICK CITY AND COUNTY COUNCIL (The Applicant) Was affixed hereto:-

 CHIEF EXECUTIVE

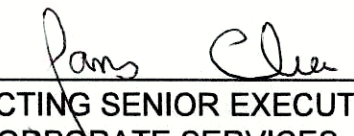
 ACTING SENIOR EXECUTIVE OFFICER,
 CORPORATE SERVICES

